

 INTERCONTINENTAL®
LONDON – THE O2



DISCOVER LONDON FROM
A FRESH PERSPECTIVE AND
CREATE TIMELESS MEMORIES



GUEST ROOMS AND SUITES

The hotel features 453 spacious guest rooms including 59 suites, fusing timeless luxury with contemporary comfort. Each room boasts king size beds, floor-to-ceiling windows, a smart tv, an espresso machine and a bath with a separate walk-in shower.



CLUB INTERCONTINENTAL

Located on the 2nd floor of the hotel, Club InterContinental is a haven away from the hustle and bustle, offering private check-in, breakfast, afternoon tea, evening canapés and all day refreshments.

Access from £50



THE SPA AND GYM

The Spa offers a luxurious and holistic approach to well-being with its state-of-the-art facilities, acclaimed treatments designed by ESPA and a team of highly-trained professionals who deliver them.

8 treatment rooms | 17m indoor pool | Sauna & steam room
24hr gym with TechnoGym equipment

A VIBRANT MIX OF DINING DESTINATIONS



MERIDIAN LOUNGE

Bright and airy lounge serving light lunches, afternoon teas and a selection of fine teas from The East India Company.

Ground Floor
Capacity: 70
+ 40 Terrace



MARKET BRASSERIE

Relaxed eatery serving seasonal produce, rich in provenance, from a theatre-style kitchen.

1st Floor
Capacity: 185



CLIPPER BAR

Maritime themed bar with spectacular views and an extensive rum and gin selection.

1st Floor
Capacity: 250



PENINSULA RESTAURANT

Award-winning restaurant serving modern European cuisine, complemented by a well curated wine list.

2nd Floor
Capacity: 60
+ 24 Private Dining



EIGHTEEN SKY BAR

Sophisticated 18th floor bar featuring stunning views over London, unique cocktails and a terrace.

18th Floor
Capacity: 150

STATE-OF-THE-ART CONFERENCE CENTRE

1ST FLOOR: ARORA BALLROOM

Designed to capture a genuine sense of place, InterContinental London – The O2 features a 4,500 sqm purpose-built conference centre including the UK's largest pillar-free ballroom with ample break-out areas, 19 additional meeting spaces and an in-house audio-visual team.

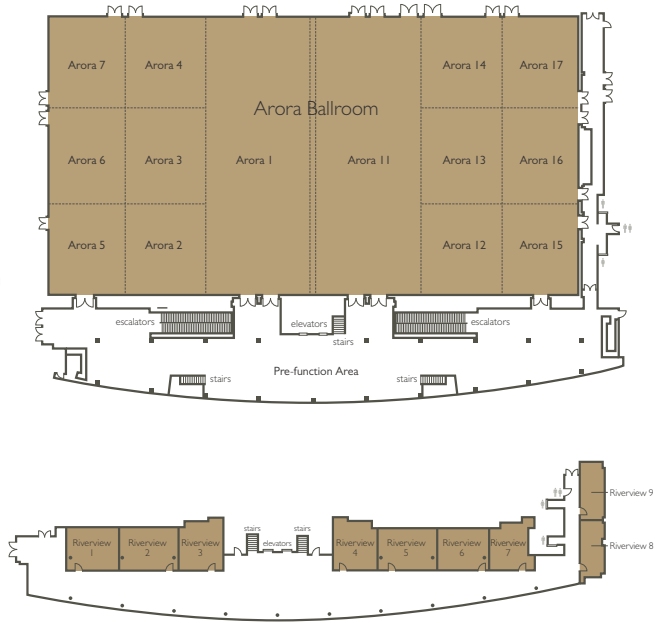
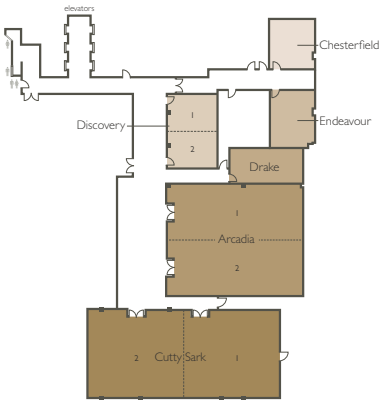

2ND FLOOR: GREENWICH SUITES

2ND FLOOR: RIVERVIEW SUITES

		Theatre (standing)	Banquet	Boardroom	Cabaret	Classroom	U-Shape	Area SQFT	Area SQM
Ground Floor	Arora Ground Foyer	800	–	–	–	–	–	7,534	700
	Docklands	55	48	15	32	20	30	613	57
1st Floor	Arora Foyer	900	–	–	–	–	–	9,117	847
	Arora 1-7 (East)	1,550	1,236	–	860	990	–	16,188	1,504
	Arora 11-17 (West)	1,550	1,236	–	860	990	–	16,188	1,504
2nd Floor	Riverview Foyer	800	480	–	430	450	–	10,473	973
	Riverview Room 1	50	30	18	24	24	18	527.4	49.4
	Riverview Room 2	50	30	24	24	27	24	570.4	53.3
	Riverview Room 3	50	30	18	16	24	18	527.4	49.4
	Riverview Room 4	50	30	18	24	24	18	629.6	58.5
	Riverview Room 5	50	30	24	24	27	24	614.6	57.1
	Riverview Room 6	50	30	18	24	24	18	462.8	43.4
	Riverview Room 7	30	20	12	16	12	12	518.8	48.2
	Riverview Room 8	30	20	18	16	12	18	316.4	29.4
	Riverview Room 10	30	20	18	16	12	18	320	29.8
2nd Floor	Chesterfield	–	–	14	–	–	–	350	32.5
	Endeavour	–	–	14	–	–	–	405.7	37.7
	Drake	30	–	26	16	15	–	427.3	39.7
	Discovery	45	48	24	24	24	26	603.8	56.1
	Arcadia	220	192	72	96	192	72	2583.3	240
	Cutty Sark	260	216	80	96	180	88	2841.6	264

GETTING TO INTERCONTINENTAL LONDON – THE O2



TRANSPORT LINKS TO HOTEL

LONDON UNDERGROUND:

North Greenwich 5 mins walk

RIVERBUS:

North Greenwich Pier 7 mins walk

PARKING:

250 car parking spaces available

BY AIR: (driving distance)

London City Airport 20 mins

London Gatwick Airport 70 mins

London Heathrow Airport 90 mins

Complimentary hotel shuttle available to and from North Greenwich Station frequently.

 **INTERCONTINENTAL.**
LONDON – THE O2

1 Waterview Drive
Greenwich Peninsula, SE10 0TW
Telephone: +44 (0)20 8463 6868
Email: info@iclondon-theo2.com

CONNECT WITH US!

@intercontheo2

InterContinental London – The O2

iclondon-theo2.com